

PAGE 238

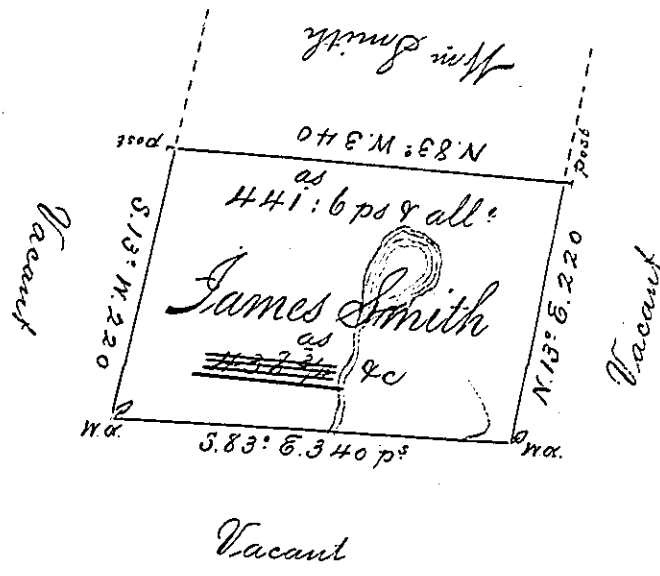

A Grant of a tract of land called  
 Situate about 2 1/2 Miles from the N. E. Branch  
 of Susque<sup>ea</sup> River including a small pond which  
 is the Head of the Easternmost Branch of Tuscarora  
 Creek in Luzerne County containing four Hundred  
 forty one acres 6 ps  
~~Eight acres~~ & Allowance of Six p Cent for  
 roads &c. Surveyed for Jas<sup>s</sup> Smith the 25<sup>th</sup> Day of  
 Nov<sup>r</sup> 178<sup>obl</sup> in pursuance of a Warrant Dated the  
 23<sup>d</sup> Day of June 1787  
 by Wm Gray D.S.

Daniel Brodhead Esq<sup>r</sup> }  
 Survey Gen<sup>l</sup> }

IN TESTIMONY that the above is a copy of the original remaining on file in the  
 Department of Internal Affairs of Pennsylvania, made con-  
 formably to an Act of Assembly approved the 16th day of  
 February, 1833. I have hereunto set my Hand and caused  
 the Seal of said Department to be affixed at Harrisburg, this  
 sixth day of October 1896.

James W. Latta  
 Secretary of Internal Affairs.